



# HYRUM CITY

83 West Main • Hyrum, Utah 84319  
Phone (435) 245-6033

Stephanie Miller, Mayor

**Council Members**

Scot M. Allgood  
Jared L. Clawson  
Martin L. Felix  
Paul C. James  
Aaron Woolstenhulme

**City Administrator**

Ron W. Salvesen

**Recorder**

Stephanie B. Fricke

**Treasurer**

Todd Perkins

January 29, 2015

## RE: NOTICE OF CONDITIONAL USE PERMIT APPLICATION

Property Owner,

The Hyrum Planning Commission will be considering an application for a Conditional Use Permit for an expansion at the current JBS plant located at 410 North 200 West. This property is located in the Manufacturing M-2 Zone. This meeting will be held on Thursday, February 12<sup>th</sup> at 6:30 p.m. in the City Council Room, 83 West Main, Hyrum. Anyone wanting to make comments about this application will need to return the enclosed comment sheet to the city offices before February 12<sup>th</sup> at 5:00 p.m.

For further information please contact Hyrum City Administrator Ron Salvesen at (435) 245-6033.

Thank You,

Hyrum City



**HYRUM CITY  
COMMENT FORM**

**Conditional Use Permit- JBS Meat Packing Plant Expansion  
February 12, 2015**

\_\_\_\_\_ I WOULD RECOMMEND THE FOLLOWING CONDITIONS

COMMENTS:

---

---

---

---

---

---

---

---

---

---

---

---

---

---

---

---

---

---

---

---

---

---

---

---

---

COMMENTOR'S NAME \_\_\_\_\_

THIS FORM MAY BE MAILED OR RETURNED TO THE HYRUM  
CITY OFFICES AT:  
83 WEST MAIN STREET  
HYRUM, UTAH 84319

OWNER:  
 400 NORTH 200 WEST  
 PLYMOUTH, UTAH 84303

ENGINEER:  
 GLEASON CONSULTANTS & ENGINEERS, L.L.C.  
 2005 S. 1700 WEST, SUITE 100  
 PLYMOUTH, UTAH 84303  
 PHONE: 435-731-4555

GENERAL NOTES:

1. UNIMPAVED VMS ACCESSIBLE PARKING SPOTS SHOWN FOR ALL ACCESSIBLE PARKING SPOTS PROVIDED = 3. UNIMPAVED VMS ACCESSIBLE PARKING SPOTS PROVIDED = 1
2. UNIMPAVED ACCESSIBLE PARKING SPOTS SHOWN FOR ALL ACCESSIBLE PARKING SPOTS PROVIDED = 3. UNIMPAVED ACCESSIBLE PARKING SPOTS PROVIDED = 1
3. UNIMPAVED ACCESSIBLE PARKING SPOTS SHOWN FOR ALL ACCESSIBLE PARKING SPOTS PROVIDED = 3. UNIMPAVED ACCESSIBLE PARKING SPOTS PROVIDED = 1
4. UNIMPAVED ACCESSIBLE PARKING SPOTS SHOWN FOR ALL ACCESSIBLE PARKING SPOTS PROVIDED = 3. UNIMPAVED ACCESSIBLE PARKING SPOTS PROVIDED = 1
5. UNIMPAVED ACCESSIBLE PARKING SPOTS SHOWN FOR ALL ACCESSIBLE PARKING SPOTS PROVIDED = 3. UNIMPAVED ACCESSIBLE PARKING SPOTS PROVIDED = 1

3. PARKING SPACES REQUIRED = 3 SPOTS PER ENTRY DEVIANT ON VMS DEPT. PARKING SPACES PROVIDED = 20

1. NUMBER OF VEHICLES ANTICIPATED ON THE PROPOSED = 6
2. NUMBER OF SPOTS TO BE PROVIDED = 6
3. TOTAL AREA = APPROX. 80,000 SQ. FT.

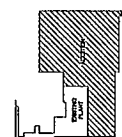

REV.	DATE	DESCRIPTION

**GLEASON CONSULTANTS & ENGINEERS, L.L.C.**  
 2005 S. 1700 WEST, SUITE 100  
 PLYMOUTH, UTAH 84303  
 PHONE: 435-731-4555

PROJECT:  
 WEST EMPLOYEE PARKING PLAN

PLANT ADDITION  
 PLYMOUTH, UTAH

DATE: 06/10/20

SCALE: 1/8" = 1'-0"

DRAWN BY: JACOB

CHECKED BY: [Signature]

